

PARIS 5 DRAWER CHEST ASSEMBLY INSTRUCTIONS

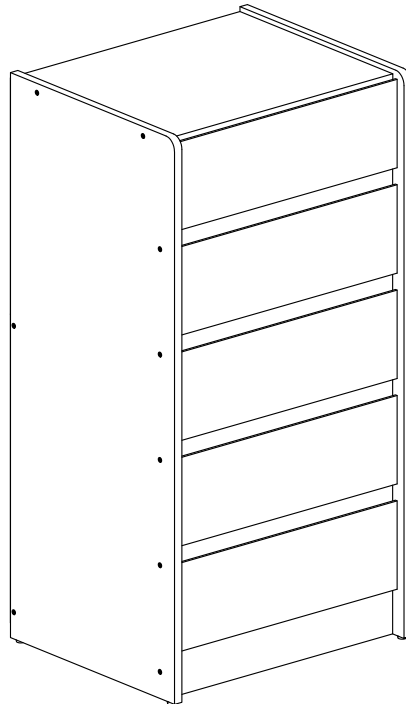

FOR DOMESTIC USE ONLY IMPORTANT PLEASE READ BEFORE YOU CONTINUE FURTHER

THE PRODUCT YOU HAVE PURCHASED WILL GIVE YOU MANY YEARS OF SERVICE IF YOU FOLLOW THE GUIDELINES FOR ITS SAFE ASSEMBLY AND PERIODIC MAINTENANCE AND CLEANING.

ASSEMBLE ON A SOFT CLEAN SURFACE.

DO NOT USE ANY TOOLS OTHER THAN THOSE SHOWN.

ANY SPANNERS OR ALLEN KEYS REQUIRED ARE INCLUDED WITH THE FITTING KIT.

DO NOT FOR ANY REASON USE A POWER TOOL TO ASSEMBLE THIS PRODUCT. ITS USE WILL INVALIDATE ANY CLAIM YOU MAY HAVE AND COULD MAKE THIS PRODUCT UNSAFE.

DEPENDING ON THE AMOUNT OF USE THIS PRODUCT RECEIVES, IT MAY BE NECESSARY TO TIGHTEN UP THE FIXINGS FROM TIME TO TIME. THIS IS COMPLETELY NORMAL FOR ANY FLAT PACK FURNITURE .

FOR CLEANING, YOU MAY USE A DAMP CLOTH (NOT WET). DO NOT USE POLISH, DETERGENT OR CHEMICAL CLEANERS.

THIS SURFACE OF THIS ITEM IS NOT HEAT RESISTANT. ALWAYS USE A PLACE MAT UNDER HOT OR COLD ITEMS TO PREVENT MARKING.

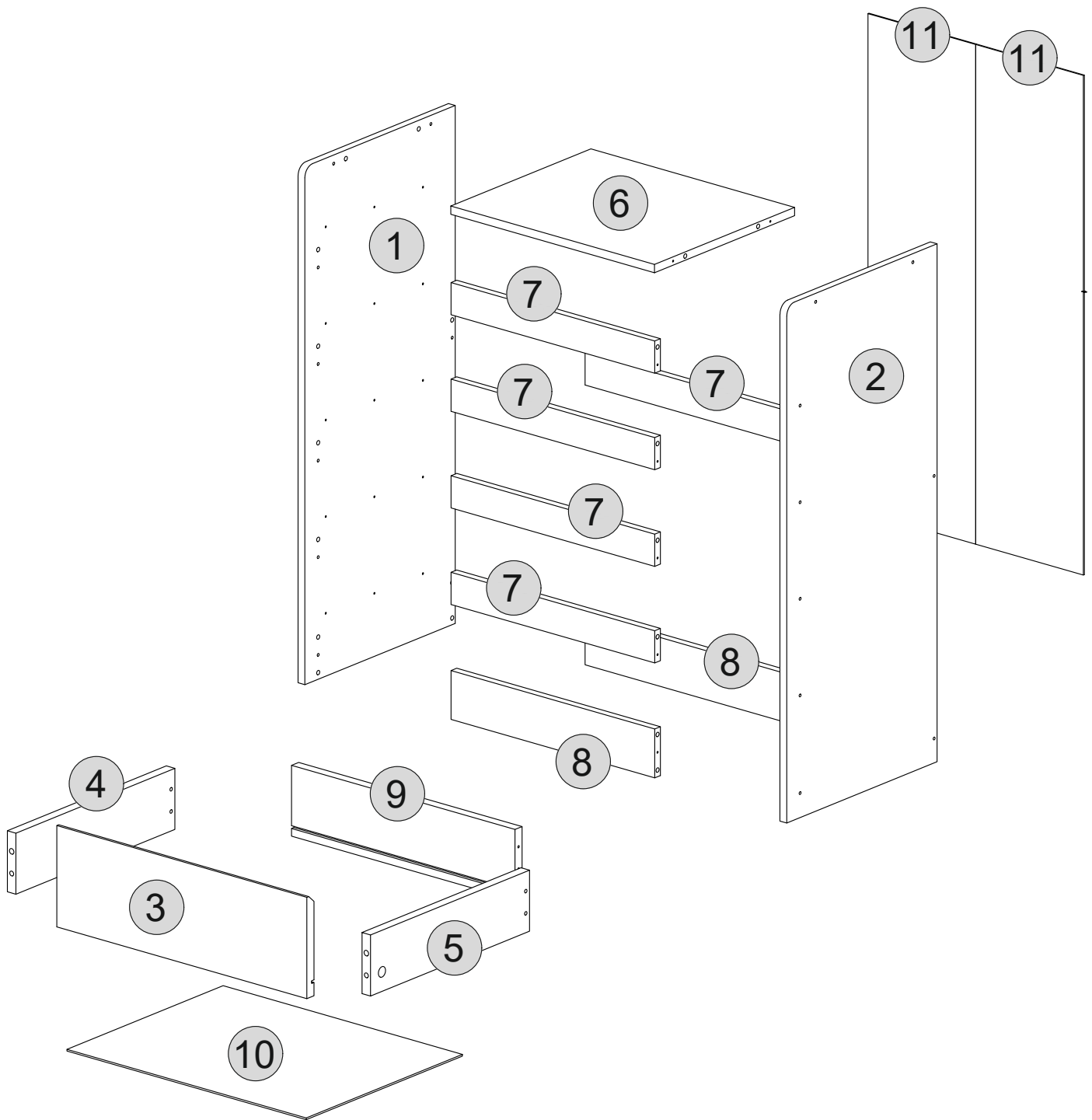

PART LIST

<u>Part Number</u>	<u>Part Code</u>	<u>Part Description</u>	<u>Quantity</u>	<u>Carton</u>
1	S100-102-195-FM1-01	Side Panel (Left)	1	1/1
2	S100-102-195-FM1-02	Side Panel (Right)	1	1/1
3	S100-102-195-FM1-03	Drawer Front Panel	5	1/1
4	S100-102-195-FM1-04	Drawer Side Panel (Left)	5	1/1
5	S100-102-195-FM1-05	Drawer Side Panel (Right)	5	1/1
6	S100-102-195-FM1-06	Top Panel	1	1/1
7	S100-102-195-FM1-07	Crossbar Panel	5	1/1
8	S100-102-195-FM1-08	Bottom Crossbar	2	1/1
9	S100-102-195-FM1-09	Drawer Backboard	5	1/1
10	S100-102-195-FM1-10	Drawer Bottom Panel	5	1/1
11	S100-102-195-FM1-11	Backboard	2	1/1

HARDWARE LIST

No	Part Name		Qty	Carton
DW6	Wooden Dowel 8 x 25mm		32 Pcs	1/1
LG1	Plastic Foot		4 Pcs	1/1
MF2	Nail		45 Pcs	1/1
MN2	Mini Fix 15mm		10 Sets	1/1
PF2	Plastic Support		20 Pcs	1/1
SC3	Screw M3.5mm x 14mm		88 Pcs	1/1
SC18	Screw M4 x 38mm		20 Pcs	1/1
SC25	FH Screw M5 x 40mm		18 Pcs	1/1
SL7	Drawer Metal Slide 350mm		5 Sets	1/1
SS3	Wall Fittings		1 Set	1/1

TIPS FOR FITTINGS CAM-LOCKS

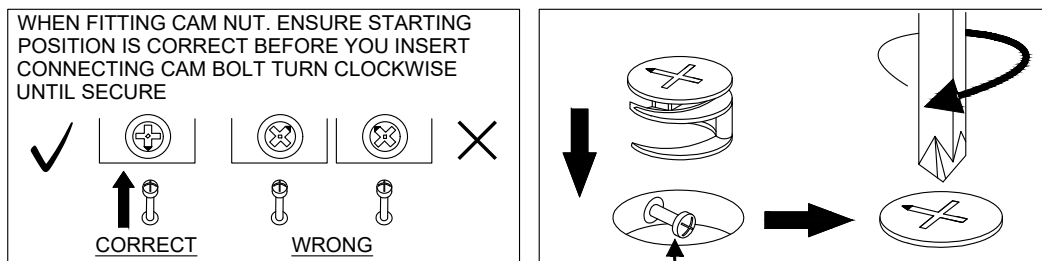

Cam bolt head needs to be in centre

CAMBOLT

Tighten until shoulder is flush with panel. Do not overtighten or undertighten (see example below)

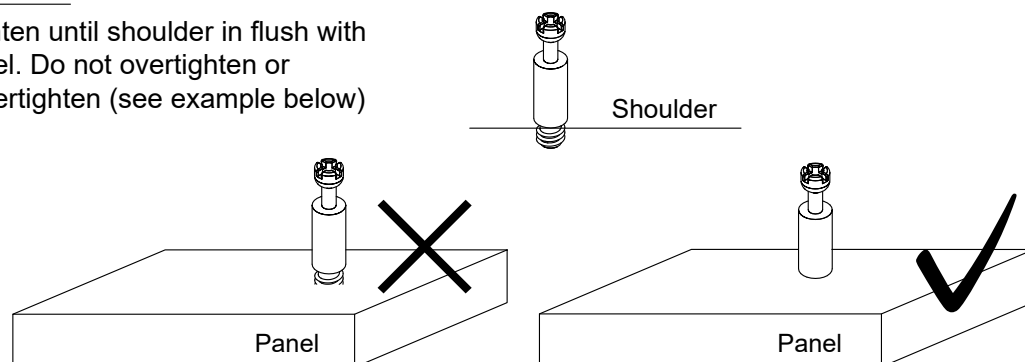

PLEASE CHECK THAT YOU HAVE ALL THE PARTS LISTED BEFORE YOU START ASSEMBLING, IF YOU DO FIND THAT SOMETHING IS MISSING, DO NOT CONTINUE ASSEMBLY. PLEASE CONTACT YOUR SUPPLIER IMMEDIATELY.

STEP 1

PARTS REQUIRED

- 6 - TOP PANEL x1
- 7 - CROSSBAR PANEL x5
- 8 - BOTTOM CROSSBAR x2

HARDWARE REQUIRED

- DW6  22

TOOLS REQUIRED

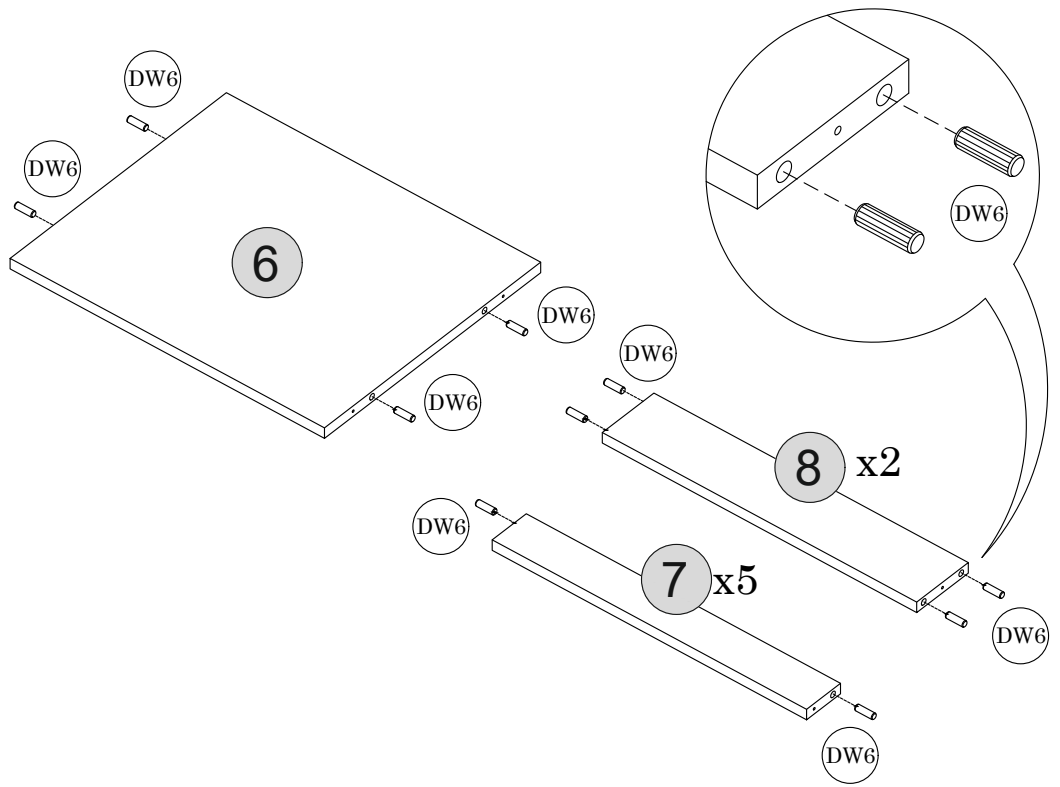
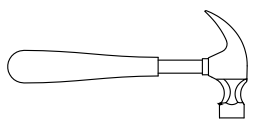

STEP 2

PARTS REQUIRED

- 1 - SIDE PANEL (LEFT) x1

HARDWARE REQUIRED

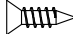
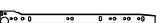
- SC3  15
- SL7  05

TOOLS REQUIRED

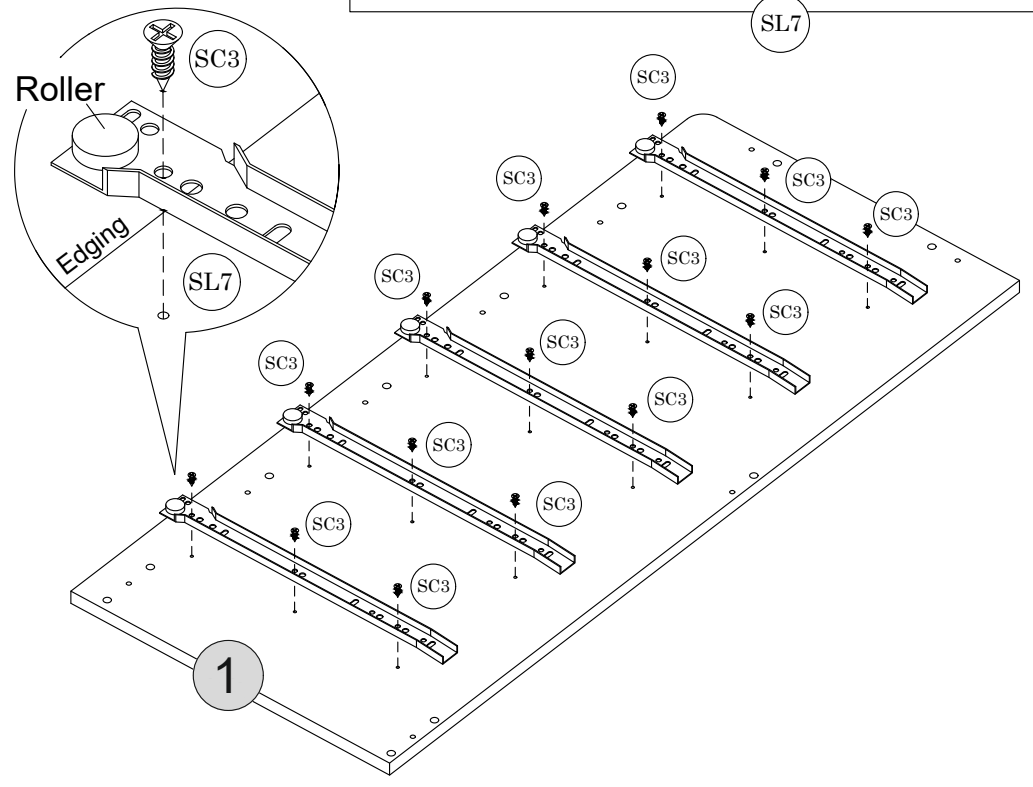
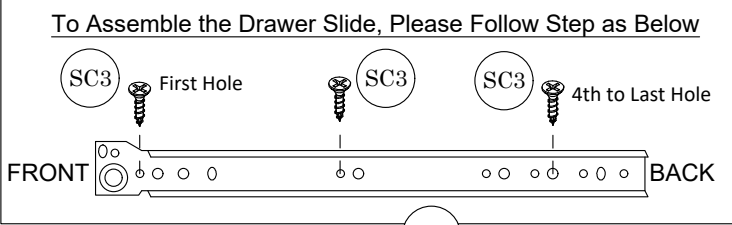
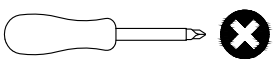

STEP 3

PARTS REQUIRED

2 - SIDE PANEL (RIGHT) x1

HARDWARE REQUIRED

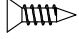
SC3  15

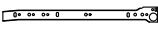
SL7  05

TOOLS REQUIRED

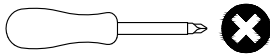

To Assemble the Drawer Slide, Please Follow Step as Below

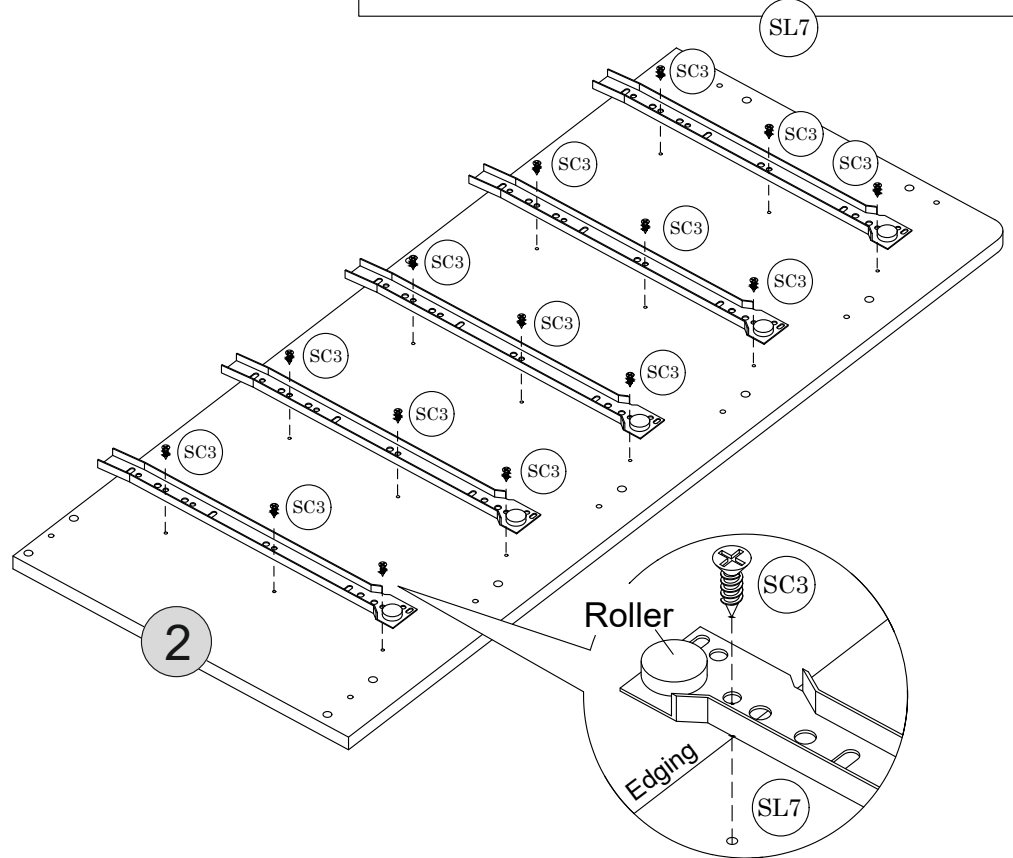
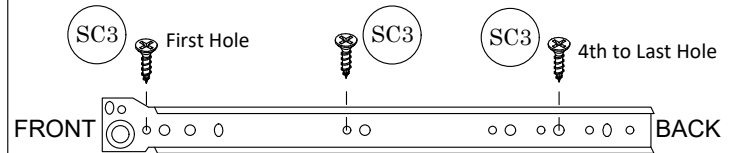

STEP 4

PARTS REQUIRED

2 - SIDE PANEL (RIGHT) x1

6 - TOP PANEL x1

7 - CROSSBAR PANEL x4

8 - BOTTOM CROSSBAR x1

HARDWARE REQUIRED

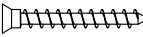
SC25  07

TOOLS REQUIRED

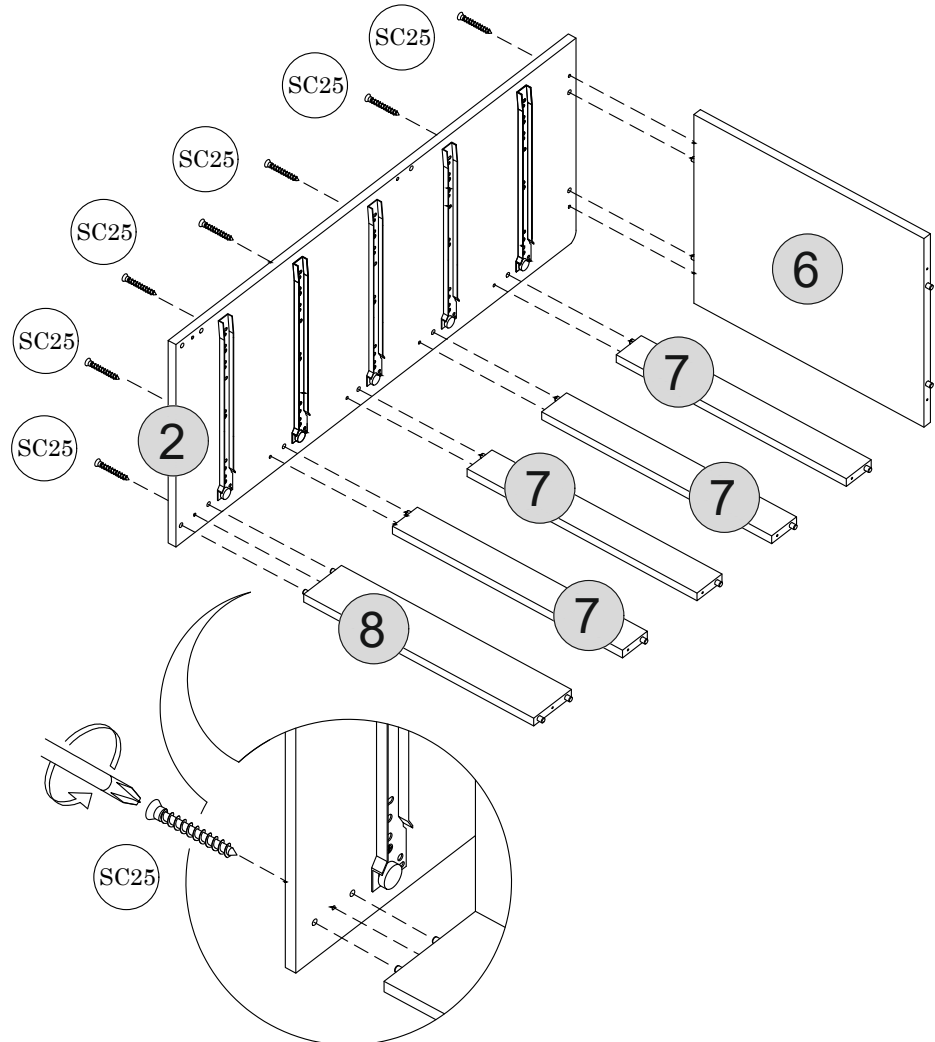
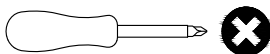

STEP 5

PARTS REQUIRED

1 - SIDE PANEL (LEFT)	x1
7 - CROSSBAR PANEL	x1
8 - BOTTOM CROSSBAR	x1

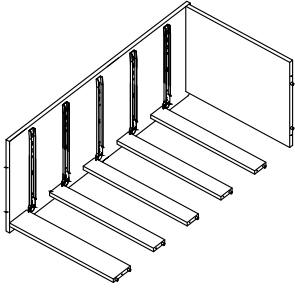

HARDWARE REQUIRED

SC25		11
------	--	----

TOOLS REQUIRED

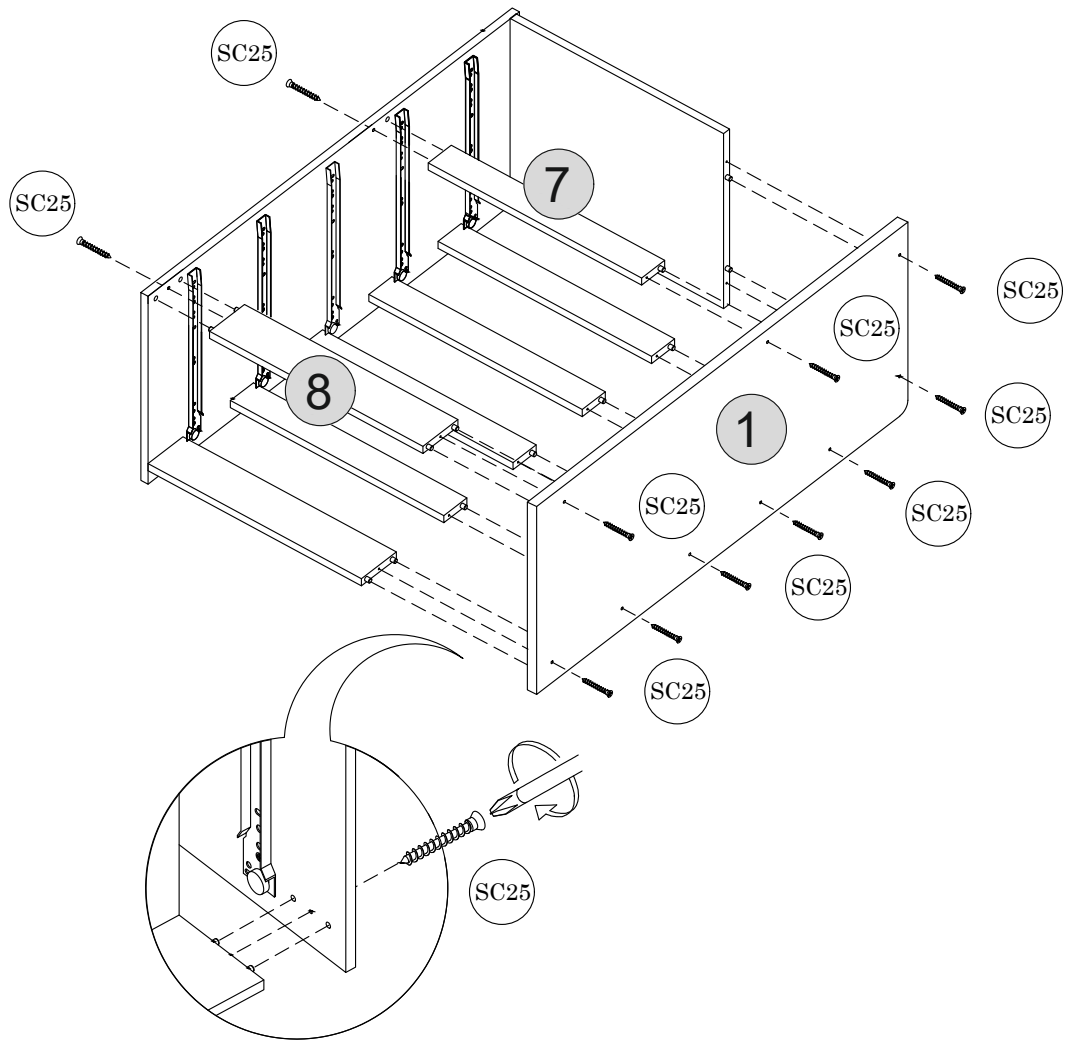
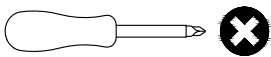

STEP 6

PARTS REQUIRED

11 - BACKBOARD	x2
----------------	----

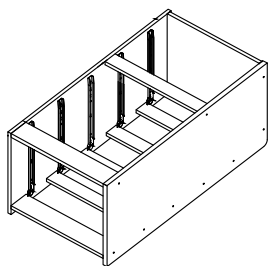

HARDWARE REQUIRED

LG1		04
MF2		15

TOOLS REQUIRED

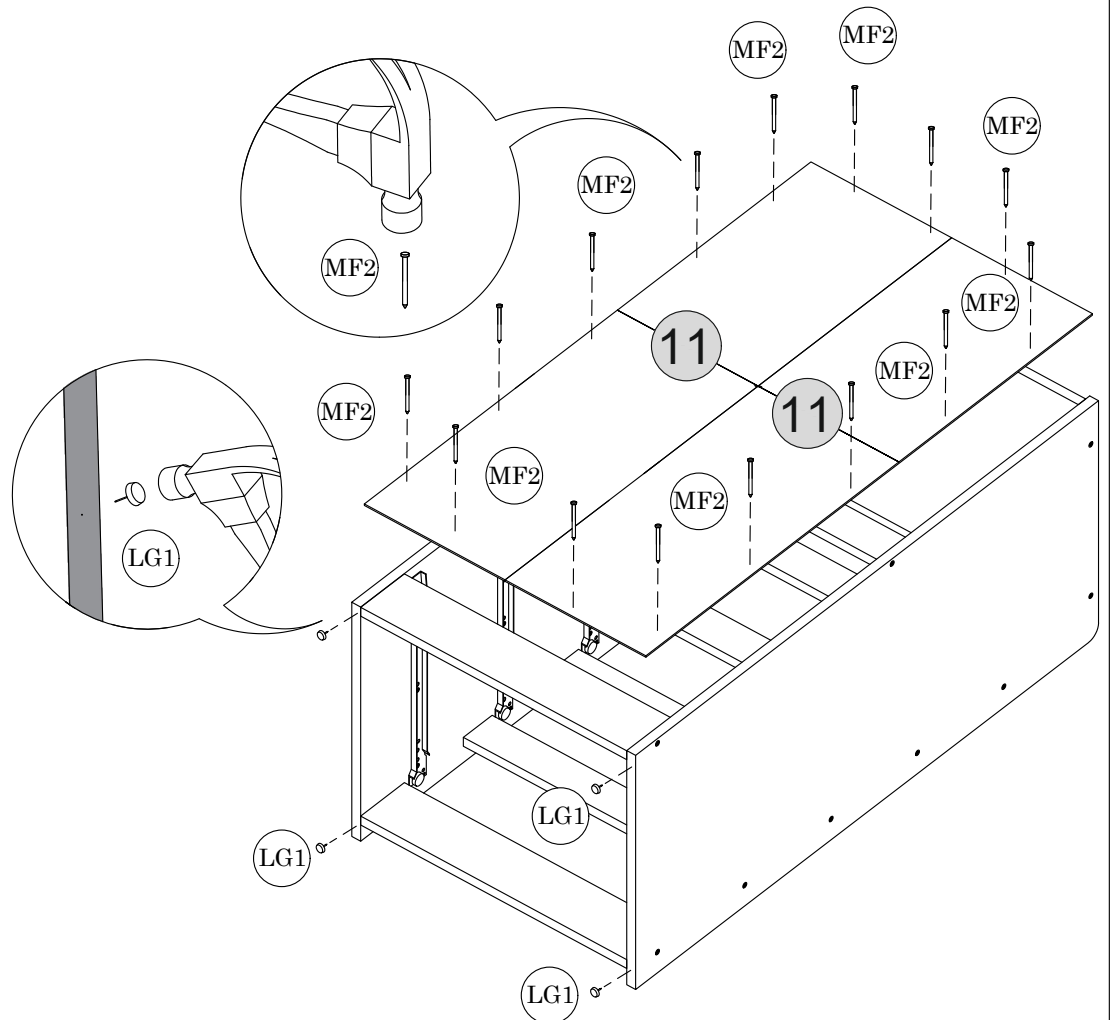
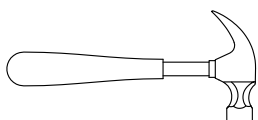

STEP 7

PARTS REQUIRED

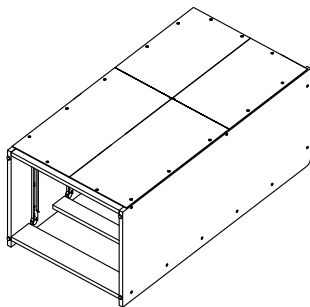

HARDWARE REQUIRED

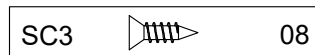

TOOLS REQUIRED

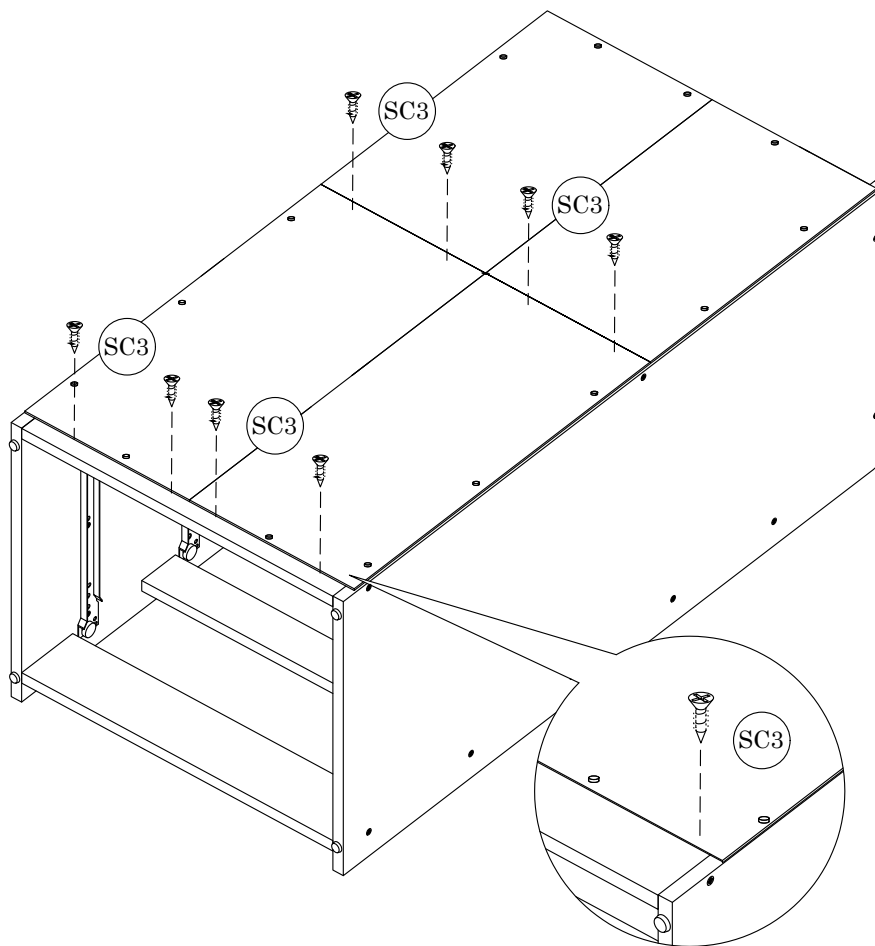
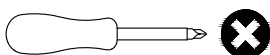

STEP 8

PARTS REQUIRED

- 3 - DRAWER FRONT PANEL x5
- 4 - DRAWER SIDE PANEL(L) x5
- 5 - DRAWER SIDE PANEL (R) x5

HARDWARE REQUIRED

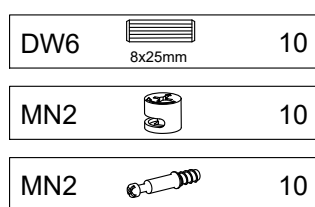

TOOLS REQUIRED

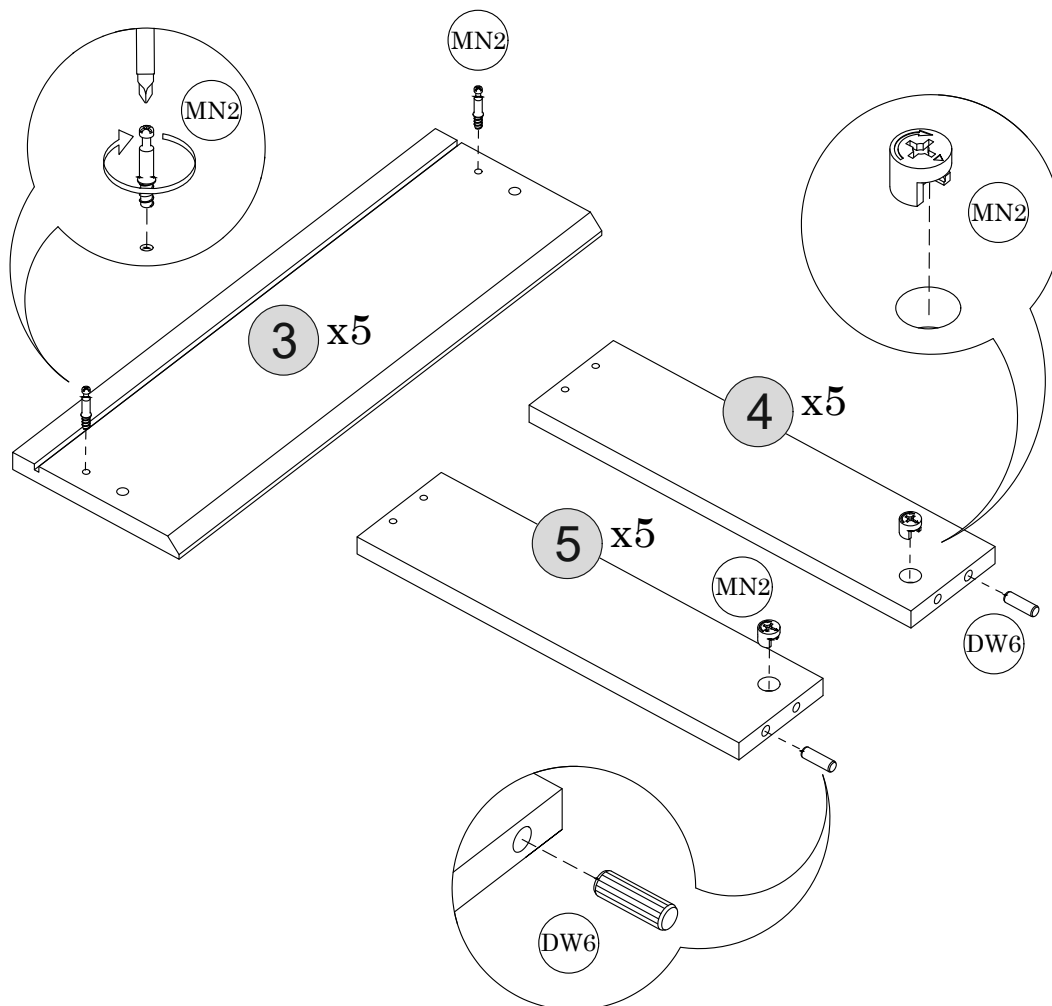
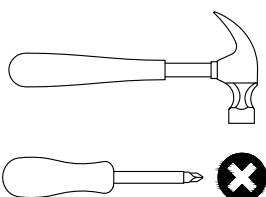

STEP 9

PARTS REQUIRED

4 - DRAWER SIDE PANEL (L) x5

5 - DRAWER SIDE PANEL (R) x5

9 - DRAWER BACKBOARD x5

HARDWARE REQUIRED

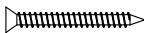
SC18  20

TOOLS REQUIRED

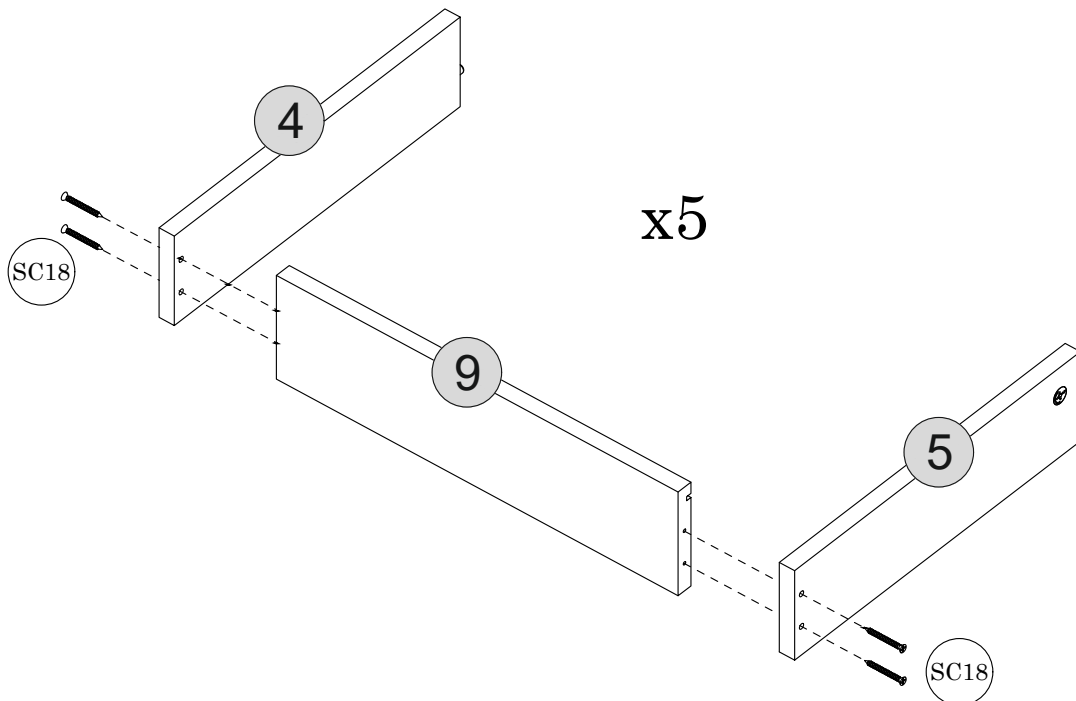
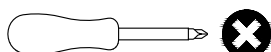

STEP 10

PARTS REQUIRED

3 - DRAWER FRONT PANEL x5

10 - DRAWER CROSSBAR x5

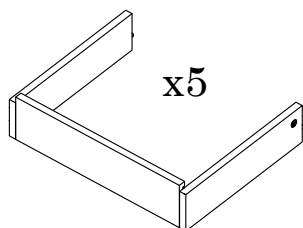

HARDWARE REQUIRED

TOOLS REQUIRED

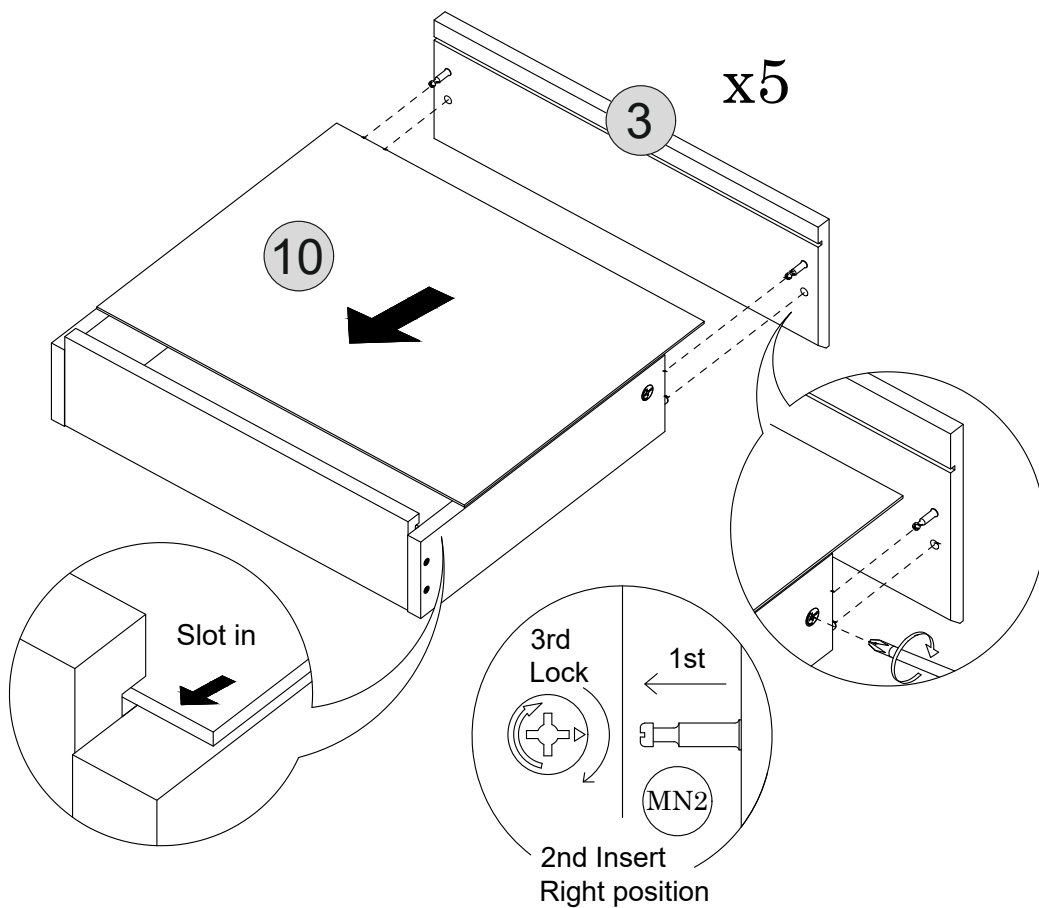
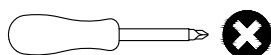

STEP 11

PARTS REQUIRED

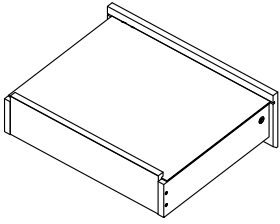

HARDWARE REQUIRED

MF2  30

TOOLS REQUIRED

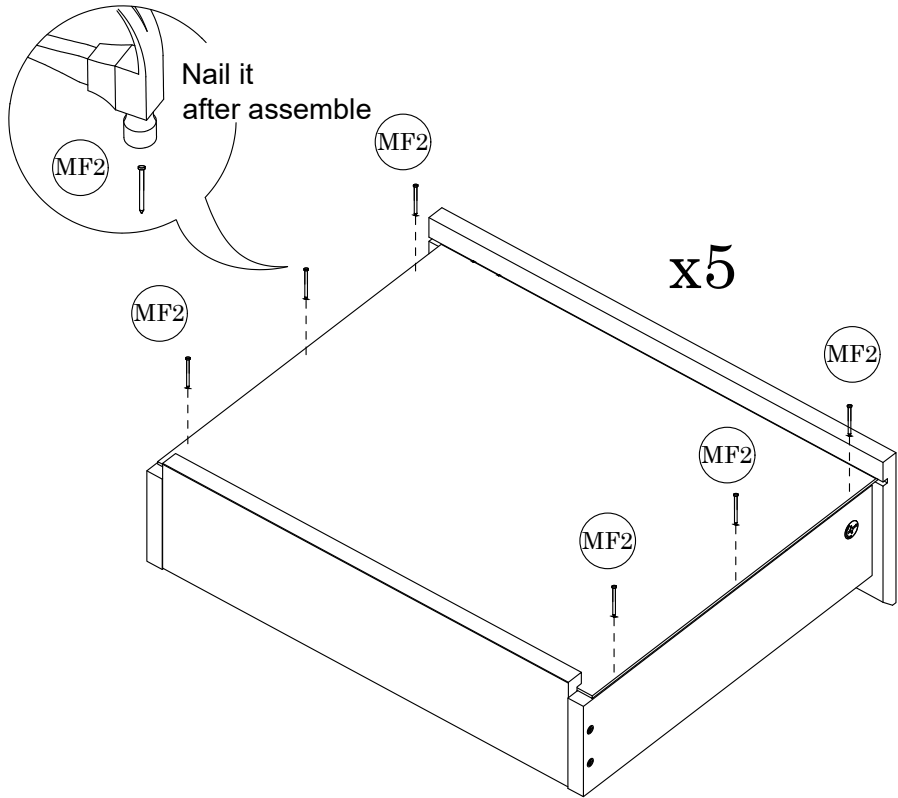
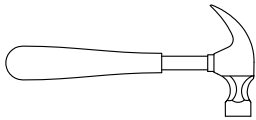

STEP 12

PARTS REQUIRED

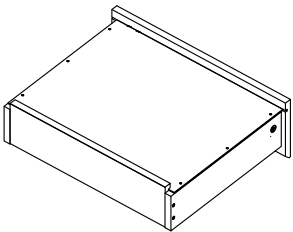

HARDWARE REQUIRED

PF2  20

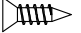
SC3  50

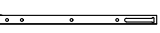
SL7  05

TOOLS REQUIRED

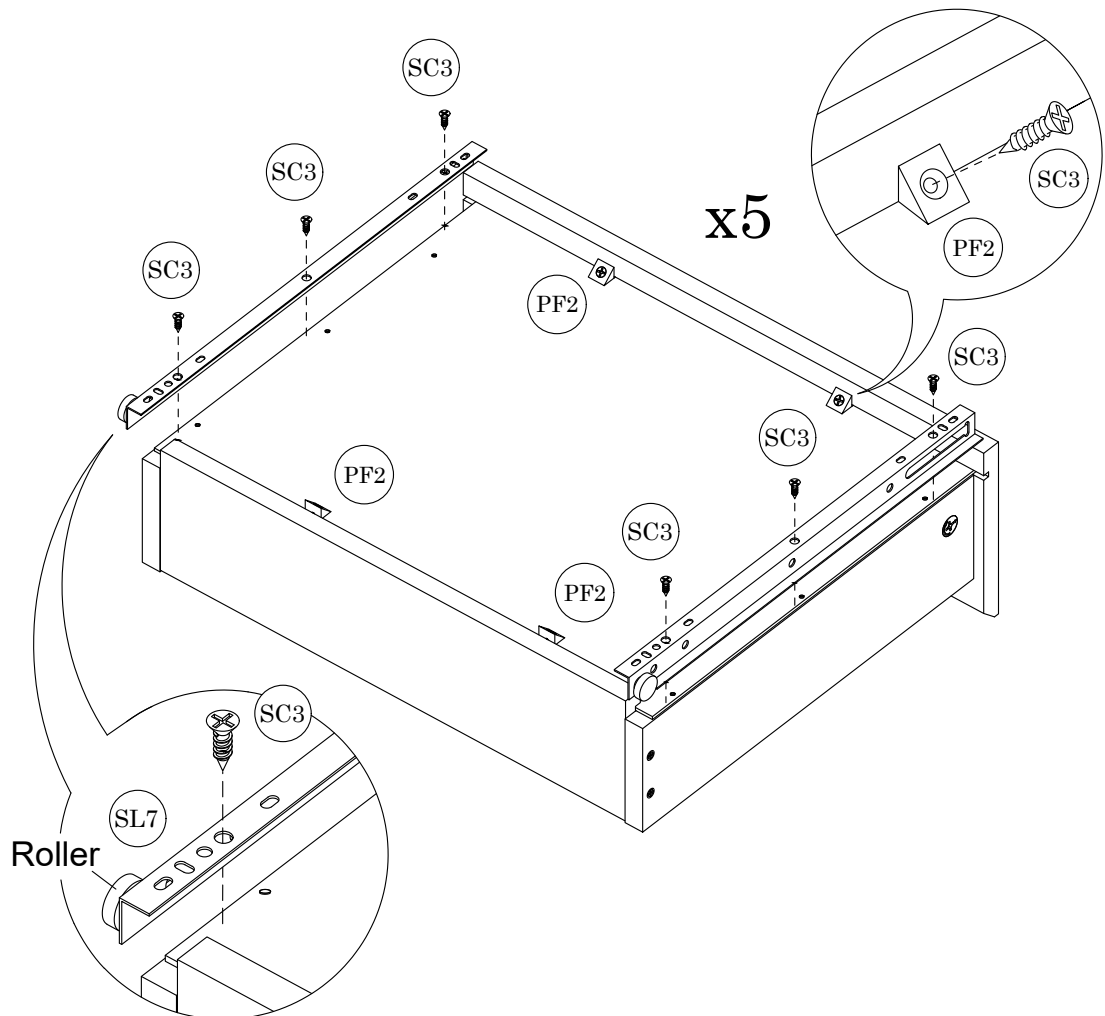
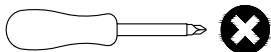

STEP 13

PARTS REQUIRED

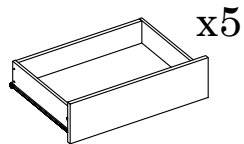
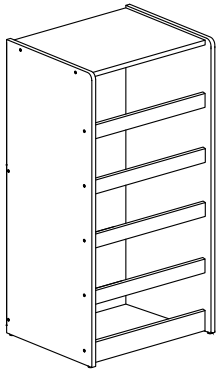

HARDWARE REQUIRED

TOOLS REQUIRED

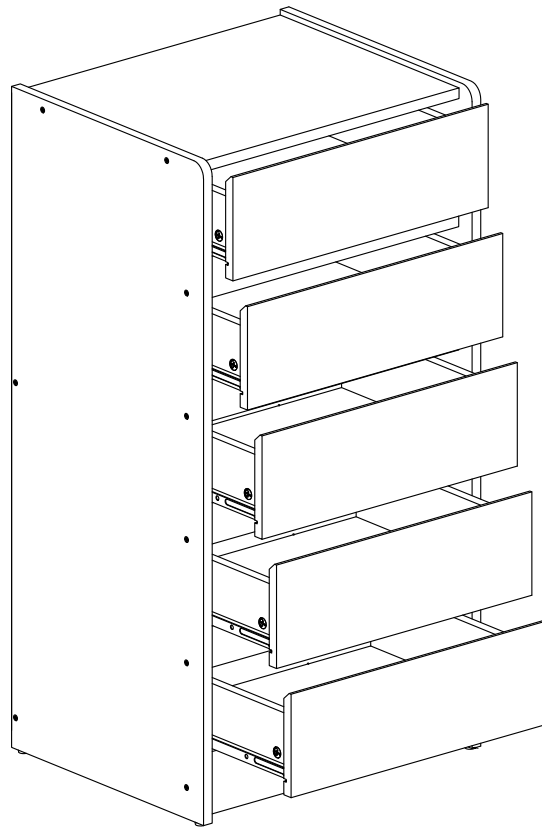

Stand up

Insert drawers

STEP 14

PARTS REQUIRED

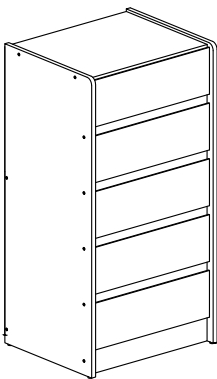

HARDWARE REQUIRED

SS3  01

TOOLS REQUIRED

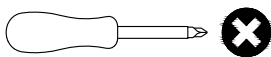

WARNING

Serious or fatal injuries can occur from furniture tipping over. To prevent the furniture from tipping over we recommend that it is permanently fixed to the wall.

Wall Fixings are not supplied with this product as different wall materials require different types of fixing devices. Please make sure you use fixings suitable for the walls in your home.

